

Forest Cutting Plan

and Notice of Intent under M.G.L.
Chapter 132 – The Forest Cutting
Practices Act, 304 CMR 11.00
(Effective Date: 3/15/16)

For DCR Use Only:

File Number _____ Case No. _____
Date Rec'd _____ Nat. Hert. _____
Earliest Start _____ Pub. Dr. Wat. _____
River Basin _____ ACEC _____
Gen. Obj. _____

Site Information

Location

Town Upton
Road Grafton Road
Acres 91 Proposed Start Date _____
Vol. MBF 166.35 Vol. Cds. 785 Vol. Tons _____

Plan Preparer

Name Philip B. Benjamin, CF
Address Benjamin Forestry Services, Inc.
151 Depot Street
Town, State, Zip South Easton, MA 02375
Phone (508) 238-0422
Type of Preparer LF
*Mass. Forester License # 15
*Required for land under Ch61, Ch61A or Forest Stewardship

Landowner

Name Town of Upton
Mailing Address Upton Conservation Commission
1 Main Street
Town, State, Zip Upton, MA 01568
Phone (508) 529-6286 / (508) 320-2678
Ch61 61A 61B Stew *Case # 303-10381
FSC CR CR Holder

Licensed Timber Harvester**

Name _____
Address _____
Town, State, Zip _____
Phone _____
Mass. Lic. Harvester # _____

**This information may be supplied after the plan is approved, but before work begins.

Best Management Practices

Stream Crossings

Indicate location on map	SC-1	SC-2	SC-3	SC-4
Type of Crossing				
Existing Structure				
Type of Bottom				
Bank Height (ft)				
Stabilization				

Wetland Crossings

Indicate location on map	WC-1	WC-2	WC-3	WC-4
Length of Crossing	30'+/-	30'+/-	25'+/-	
Mitigation	FR/DR	FR/DR	FR/DR	
Stabilization	CO	CO	CO	

Filter Strips

Indicate location on map	FS-1	FS-2	FS-3	FS-4
Width (50', 100', or VA)	50'			

Harvesting in Wetlands

Indicate location on map	HW-1	HW-2	HW-3	HW-4
Forest Type (see pg 2)				
Acres to be Harvested				
Resid. Basal Area (>50%?)				

Service Forester Comments

Codes

Type of Preparer	Type of Crossing	Stabilization	Mitigation	Type of Bottom
LF Mass. Lic. For.	CU Culvert	SE Seed	FR Frozen	LE Ledge
TH Lic. Tim. Har	BR Bridge	MU Mulch	DR Dry	ST Stony
TB Timber Buyer	FO Ford	CO Corduroy	OT Other	MU Mud
LO Landowner	PO Poled	ST Stone		GR Gravel
OT Other	OT Other	HB Hay Bales		OT Other
		OT Other		

Note:
Applicant must provide DCR with all relevant information before plan may be approved and cutting may begin. Some forestry activities, such as prescribed burning and pesticide or fertilizer application may require additional permits. Consult MA Forestry BMP Manual for further information.

If Other (OT) is used in any category an explanation must be given on an attached narrative page

Products to be Harvested*

Species	Mbf/Cds		Mbf/Cds
White Pine	19.6 MBF	Red Maple	5.425 MBF
Red Pine		Sugar Maple	
Pitch Pine		Red Oak	41.365 MBF
Hemlock		Black Oak	99.595 MBF
Spruce		White Oak	
Other Sftwd.		Other Hdwd.	785 cds
White Ash		Total Mbf	166.35
Beech		Cordwood (Cds)	785
White Birch	0.15 MBF	SW Pulp (Tons)	
B & Y Birch	.215 MBF	HW Pulp (Tons)	
Black Cherry		Chips (Tons)	

*Note: Volumes indicated in the Plan are as reported by the plan preparer and have not been independently verified by the service forester upon approval. Mbf = thousand board feet.

Cutting Standards

Indicate location on map	ST-1	ST-2	ST-3	ST-4
Forest Type	OM	WP	OH	OM
Acres	64.9	5.5	8.9	11.9
Landowner Objective	LT	LT	LT	LT
Designation of Trees	CT	CT	CT	CT
Type of Cut	SE / CT	SE / CT	SE / CT	CC
Source of Regeneration	AD / SE	AD / SE	AD / SE	CO / SE

Landowner Signature

The most important information on a cutting plan is the Landowner's objective, as this will determine which trees will be harvested and which will remain; **this decision will also determine the future condition of the forest for decades to come.** After having read the Massachusetts Forest Cutting Plan Information Sheet on page one, indicate your objective by checking the appropriate box below.

LT - Long-term Forest Management

Planned management of the forest to achieve one or more of the following objectives: produce immediate and maximize long-term income, enhance wildlife habitat, improve recreational opportunities, protect soil and water quality, or produce forest specialty products.

ST - Short-term Harvest

Harvest of trees with the main intention of producing short-term income with minimal consideration given to improving the future forest condition, which often results in a forest dominated by poor quality and low value species.

I (we) have read the Massachusetts Cutting Plan Information Sheet, and am aware of my (our) management options.

I (we) hereby certify that I (we) have the legal authority to carry out the operation described above.

I (we) certify that I (we) have notified the Conservation Commission in the town in which the operation is to take place and the abutters of record within two hundred feet of the area to be harvested.

I (we) understand that the volumes in this plan have not been independently verified by the service forester upon approval and will report final values and volumes to the Director or his/her agent if the final figures differ from those reported.

Signature of landowner(s)

Date

Determination and Status

Approved Disapproved Expires _____
Cutting Plan

Signature of Service Forester/Director's Agent

Date

Extension 1 2 Expires / / Ser. For. Ints. / /

Amendment App 1 Dis 1 App 2 Dis 2 / /

Final Report and Comments

I hereby certify that the afore described Forest Cutting Plan and all relevant statutes have been substantially complied with.

Signature of Service Forester/Director's Agent

Date

Forest Types				Designation of Trees			Type of Cut		Source of Re-generation					
WP	White Pine	HK	Hemlock	OM	Mixed Oak	CT	Cut Tree	SH	Shelterwood	Intermediate Harvests:	AD	Advanced		
WK	WP/Hem	HH	Hem/Hdwd	RM	Red Maple	LT	Leave Tree	ST	Seed Tree	CT	Commercial Thin	SE	Natural Seed	
WH	WP/Hdwd	BC	Blck Cherry	BE	Beech	SB	Stand Boundary	CC	Clear Cut	NT	Non Com Thin	PL	Plant	
WO	WP/Oak	BB	Bee/Bir/Map	SF	Spruce/Fir	OT	Other	SE	Selection	Non-Standard Systems:*				
RP	Red Pine	OH	Oak/Hdwd	SM	Sugar Maple	Landowner Objective			SA	Salvage	HG	Highgrade*	DS	Direct Seed
SR	Red Spruce	OR	N Red Oak	PP	Pitch Pine	LT	Long-term Mgt.	SN	Sanitation	DL	Diameter Limit*	OT	Other	
						ST	Short-term Har.			OT	Other*			

*If Other (OT) or a non-standard system is used an explanation must be given on attached narrative page

Forest Cutting Plan

Landowner Upton Con Comm

Narrative Page (Effective Date: 1/1/04)

Town Upton

Use this page to provide further explanation or if Other (OT) was used in any category on pages 3 or 4.

File Number _____

BMPs

Use this Section to provide further explanation or if Other (OT) was used in any category in the Best Management Practices Section on Page 3.

Please see Page 5 for the BMP's.

Designation of Trees

Use this Section to describe the types of trees to be harvested and/or retained if Other (OT) was used for "Designation of Trees" in the Stand Treatment Section on page 4.

Stand No.	Species to be Cut	Size of Trees to be Cut	Quality of Trees to be Cut	% BA/Acre Removed
_____	_____	_____	_____	_____
_____	_____	_____	_____	_____
_____	_____	_____	_____	_____
_____	_____	_____	_____	_____

Regeneration & Future Condition

Use this Section to describe how Chapter 132 requirements will be met if a non standard system (HG, DL, or OT) was used for the "Type of Cut" in the Cutting Standards Section on page 4.

Stand No.	Source of Regeneration (ex. AD, SE)	How will Regeneration be obtained/protected? If using AD - Describe the species present and how the regeneration will be protected If using SE - Describe the source of the seed and the number of seed trees/acre

Stand No.	Desired Future Condition
ST-1	Describe what the stand is expected to look like five years from the harvest, including the condition of the overstory & understorey The stand will consist of varying densities of mixed oak and other occasional mixed hardwood poles and sawlogs as well as individual and small to medium pockets of white pine saplings, poles, and occasional sawlogs. The understorey will consist of huckleberry, sweet pepperbush in areas, briars, other shrubs, occasional mixed hardwood stump sprouts, and flourishing herbaceous species. The mixed oak and white pine seedlings should begin to thrive as well with the additional sunlight.
ST-2	This stand will consist of an aesthetically appealing mix of well spaced, better formed white pine poles and sawlogs with infrequent mixed oak and mixed hardwood saplings, poles, and sawlogs. Areas of fair to excellent white pine regeneration in the sapling class will really benefit as will the huckleberry, mixed shrubs, occasional mixed hardwood stump sprout sprouts, and flourishing herbaceous species. The mixed oak and white pine seedlings should begin to thrive as well with the additional sunlight.

Forest Cutting Plan

Narrative Page (Effective Date: 3/15/16)

Use this page to provide further explanation or if Other (OT) was used in any category on pages 3 or 4.

Landowner Town of Upton Con Comm

Town Upton

File Number _____

BMPs

Use this Section to provide further explanation or if Other (OT) was used in any category in the Best Management Practices Section on Page 3.

Designation of Trees

Use this Section to describe the types of trees to be harvested and/or retained if Other (OT) was used for "Designation of Trees" in the Stand Treatment Section on page 4. Additional narrative description may be added on a separate page.

Stand No.	Describe Trees to be Cut			Describe Trees to be Left			% BA/AC	
	Species	Size	Quality	Species	Size	Quality	Cut	Left

Regeneration & Future Condition

Use this Section to describe how Chapter 132 requirements will be met if a non standard system (HG, DL, or OT) was used for the "Type of Cut" in the Cutting Standards Section on page 4.

Stand No.	Source of Regeneration (ex. AD, SE)	How will Regeneration be obtained/protected? If using AD - Describe the species present and how the regeneration will be protected If using SE - Describe the source of the seed and the number of seed trees/acre
------------------	--	---

Stand No.	Desired Future Condition Describe what the stand is expected to look like five years from the harvest, including the condition of the overstory & understory
------------------	--

ST-3	The stand will consist of varying densities of better formed, mixed oak and other mixed hardwood poles and sawlogs with a developing component of mixed oak, mixed hardwood, and white pine saplings and small poles. The understory will consist of hazelnut and other shrubs, occasional mixed hardwood stump sprouts, and flourishing herbaceous species, especially with the additional sunlight.
ST-4	This stand will consist of dense sapling growth, both single stems and stump sprouts, of mixed oaks and occasional red maple and other mixed hardwoods. Very infrequent white pine seedlings and saplings will also be present as will a dense understory with huckleberry and other shrubs and flourishing herbaceous species.

Forest Cutting Plan

Narrative Page

Landowner	Town of Upton
	Conservation Commission
Town	Upton
File Number	

BMPs

This project has been marked in an effort to begin to satisfy the management prescriptions as outlined in the Forest Stewardship Plan for the Warren Brook Watershed Conservation Area off Grafton Street in North Upton. The marking is designed to improve the growing conditions of the legacy trees and future crop trees within the treatment area. This will be accomplished through the removal of individual and small groups of mixed hardwood and occasional white pine sawlogs for lumber as well as poor quality hardwoods for firewood. This work will improve the spacings between the retained trees, helping to reduce the stress associated with overstocking. Although quite a few of those hardwoods that have died recently due to insect defoliations in combination with droughty summers will be removed, many others will be left behind to serve as cavity trees for the wildlife in the area.

The removals will also enhance the growing conditions of the young hardwood and white pine saplings and small poles. Although some of these young trees will be damaged or destroyed during the project, the opportunity for the natural regeneration of the oaks and white pine will be greatly improved with the exposed mineral soil and added sunlight. The older white pines within the treatment area have a moderate amount of first year white pine cones that will be maturing during the summer of 2020. The seeds that drop will be able to take advantage of the disturbed soil for improved germination. The opportunity for better oak regeneration will also be improved with the creation of occasional, slightly larger openings that will enjoy more sunlight for a longer period of time while the oaks germinate and begin to develop their root systems.

In addition to the individual and small group selection harvest and improvement thinning, two areas have been identified and marked for the creation of early successional habitat. All of the trees greater than 4 inches in diameter will be removed in an effort to increase the habitat diversity within the property. The responding dense growth of young tree stems will be hugely helpful in attracting and retaining those species of wildlife that require that type of habitat for nesting, feeding, and cover.

There are several stretches along the existing wood roads that tend to be seasonally wet during periods of high precipitation. The lack of any defined channel identify these as ephemeral wetlands. The loggers will protect these areas with a combination of log corduroy, timber mats, and/or steel plates that will ensure the water flow is uninterrupted and silt-free as the flows cross the existing wood roads. It should be noted that there are occasional lower areas through the treatment area that tend to be seasonally wet and have not been marked for the project. Trees adjoining these seasonally wet areas have been marked to be felled away from any of these areas.

Locus Map

Warren Brook Watershed Conservation Area
Upton, Massachusetts

Owner: Town of Upton
Upton Conservation Commission
1 Main Street
Upton, MA 01568

USGS Quadrangle
Milford, MA



Scale 1" : 24,000"

Prepared By
Thomas P. Farrell
Benjamin Forestry Services, Inc.
So. Easton, Massachusetts 02375
January 20, 2020

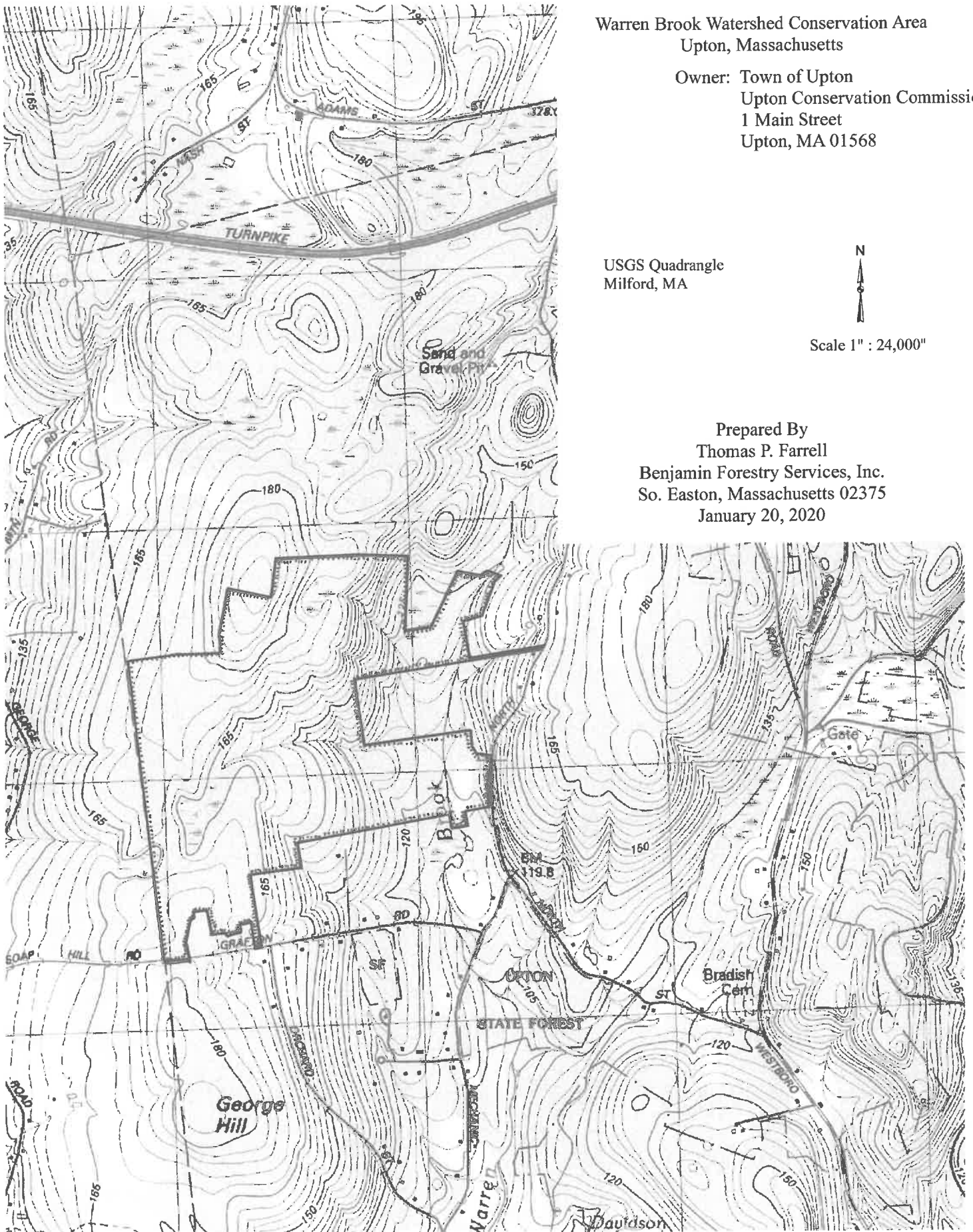

Warren Brook Watershed Conservation Area
 Upton, Massachusetts

Owner: Town of Upton
 Upton Conservation Commission
 1 Main Street
 Upton, MA 01568



Scale 1"=660'

Legend

- Forest Type Boundary
- ST-# Forest Type Code - See Page 2
- ESC Early Successional Clearing
- Existing Wood Road
- Perennial Stream
- Seasonal Stream
- //// 50' Filter Strip
- Wc-# Wetland Crossing - See Page 1
- ≡ Seasonally Wet Pocket
- L Proposed Landing
- OUT Different Owner
- Treatment Area

Prepared By
 Philip B. Benjamin, CF and Thomas P. Farrell
 Benjamin Forestry Services, Inc.
 So. Easton, Massachusetts 02375
 January 30, 2020